

morphy richards®

Storm hard floor cylinder vacuum cleaner

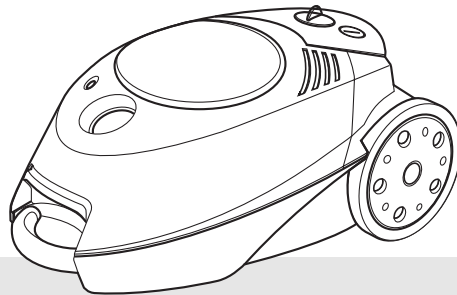

Please read and keep these instructions



getting the best from
your new cleaner...

If your cleaner isn't picking up as well as it should, please check

- **Dustbags**

It is important to replace them when the dustbag indicator shows red, otherwise the performance of the cleaner will be impaired. Call our parts helpline.

- **Filters**

It is important that the filters are cleaned regularly or replaced to allow air through the appliance.

- **Blockages**

Check the nozzle, tubes and hose for blockages.

- **Stairlock**

The stairlock mechanism makes a slight clicking when the wheels turn, this is normal.



www.morphyrichards.com

Important safety instructions

The use of any electrical appliance requires the following of common sense safety rules.

Primarily there is danger of personal injury and secondly danger of damage to the appliance and property. These are indicated in the instructions text by the following two conventions:

WARNING: Danger of personal injury

IMPORTANT: Damage to the appliance

In addition we offer the following essential safety advice.

Location

- Do not use or keep this product outside when it is raining.
- Do not store the appliance near hot ovens or heating appliances.

Mains lead

- Do not allow the mains lead to become strained or run this appliance over it.
- If the electrical cable becomes damaged the complete cable assembly must be replaced. Do not attempt this task yourself, contact us using the helpline number.

Children

- Children do not understand the dangers associated with operating electrical appliances. Never allow children to use this appliance.

Other safety considerations

- Never use in the presence of explosive liquids or vapours.
- Never pick up inflammable or poisonous liquids such as petrol, copier toner, or other volatile substances. Never pick up acids, asbestos or asbestos dust.

- Always disconnect the appliance from the mains supply after use or prior to cleaning or replacing dust bags.
- The appliance should never be left running unsupervised.

Product safety

- Never use the appliance without the filter installed.
- Never use the appliance to vacuum hot ashes, broken glass, sharp objects or liquids.
- Never modify the cleaner in any way.
- Repairs to electrical appliances are only to be undertaken by trained personnel. Unprofessional repairs can be dangerous for users.
- Use only genuine Morphy richards spare parts and accessories.

Electrical requirements

Check that the voltage on the rating plate of your appliance corresponds with your house electricity supply which must be A.C. (Alternating Current).

If the socket outlets in your home are not suitable for the plug supplied with this appliance, the plug should be removed and the appropriate one fitted.

If you cut off the plug and let go of the cable it will rewind into the machine. Therefore you must pull out a length of cable and secure it before cutting off the plug and refitting a new one.

WARNING: The plug removed from the mains lead, if severed, must be destroyed as a plug with bared flexible cord is hazardous if engaged into a live socket outlet.

Should the fuse in the 13 amp plug require replacement, a BS1362 13 amp fuse must be fitted.

Features

- ❶ Dust compartment cover
- ❷ Hose inlet
- ❸ Bag full indicator
- ❹ Tool storage compartment cover
- ❺ Variable power control
- ❻ Cable rewind switch
- ❼ Tube standby slot
- ❽ Tube park
- ❾ On/off switch
- ❿ Dust compartment release lever
- ⓫ Exhaust filter
- ⓬ Motor protection filter
- ⓭ Dust bag safety lock
- ⓮ Slot for attaching dust bag holder
- ⓯ Carrying handle

Accessories you should have:

- ❶❷ Suction hose with air flow control
- ❶❸ Two metal tubes
- ❶❹ Hard floor brush
- ❶❺ Floor nozzle
- ❶❻ Paper dust bag
- ❶❼ Dust bag holder
- ❶❽ Crevice tool
- ❶❾ Brush attachment
- ❶❿ Upholstery nozzle

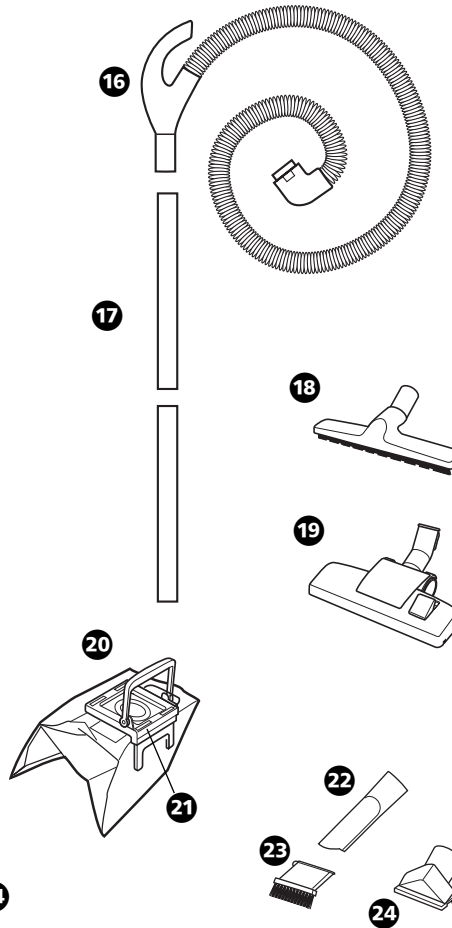
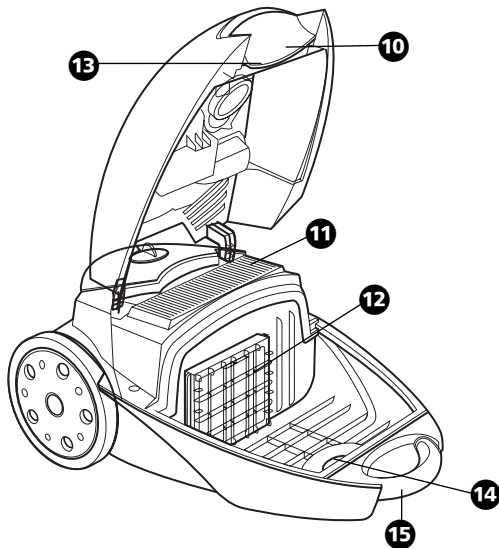
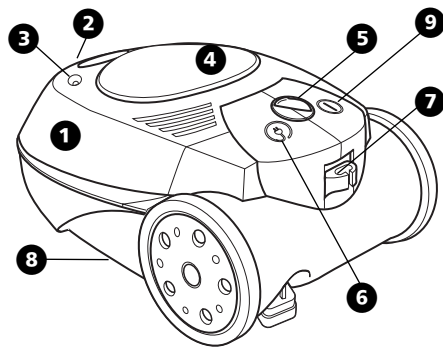

Tools and accessories

Standard floor nozzle 19

This nozzle is suitable for general purpose cleaning on a wide variety of floor coverings.

Hard floor brush 18

Designed specifically for use on wood, tiles and all other hard floor types.

Tool storage

The upholstery nozzle 24, and the crevice tool 22 and brush attachment 25 are stored in the internal storage compartment. Lift to open.

Operation

Suction hose

Push the 360° rotating head on the suction hose 16 into the suction hose opening 2 on the vacuum cleaner.

The appropriate cleaning tool can be attached directly to the other end of the suction hose or the metal tubes can be used between the suction hose and the tool.

Switching on

Always pull out the supply cable to its maximum length. Plug the appliance into the mains supply. Ensure that the variable power control 5 is set to minimum by turning the dial anti-clockwise as far as it will go. Push the on/off switch 9 to start the motor. Turn the variable power dial clockwise to the desired power.

| Standard accessories | Application |
|---|--|
|  |  Curtains and delicate fabrics |
|  |  Textiles and upholstery |
|  | Shelves and hard surfaces |
|  |  Carpets and other textile floor coverings (brushes up) |
|  |  Settings for heavy dirt and smooth floors (brushes down) |

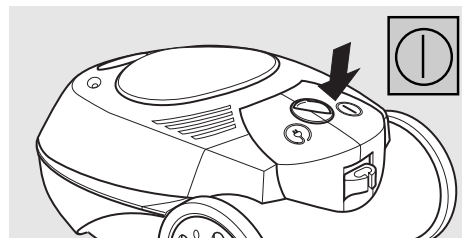
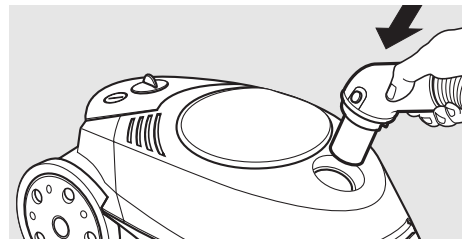
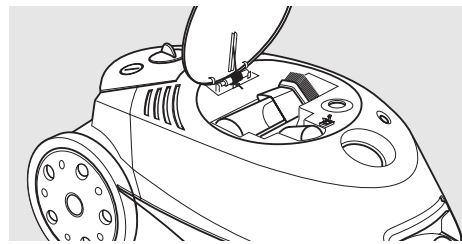

Controlling suction power

The suction power can be varied to suit the surface being cleaned, by using the variable power control ⑤. See table for guideline settings.

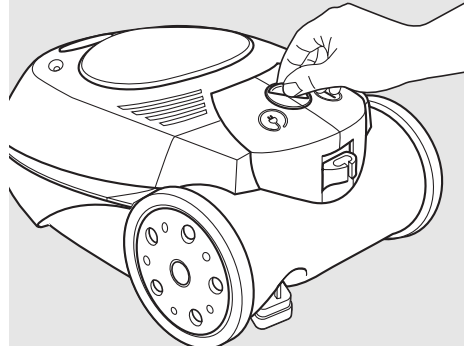

The suction power can also be adjusted using the fingertip control on the handle.

- Closed: full suction
- Open: reduced suction

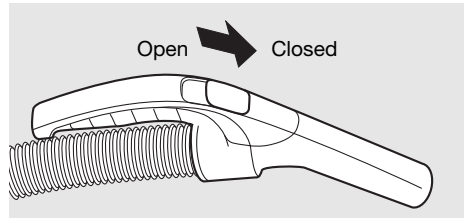

Recommended settings

Alter the power setting to suit surface.

| Power setting | Application |
|---------------|---|
| | Curtains and delicate fabrics |
| | Textiles and upholstery |
| | Floor coverings such as rugs or economy setting for carpets |
| | Carpets or hard floor coverings |

Tube standby

During short breaks in cleaning the tubes can be held in an upright, 'standby' position **7**, whilst you move furniture for instance.

IMPORTANT: Ensure that the appliance is never left unattended whilst it is switched on.

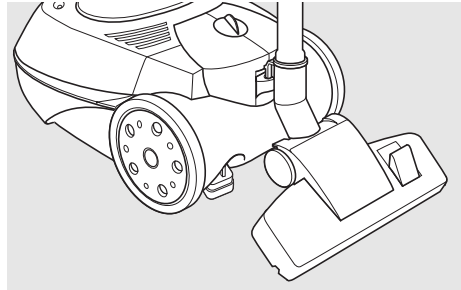

Switching off

Switch off the appliance. Remove the plug from the mains supply and rewind the power cable using the cable rewind switch **6**.

WARNING: When using the cable rewind, always hold the plug as the cable will rewind quickly.

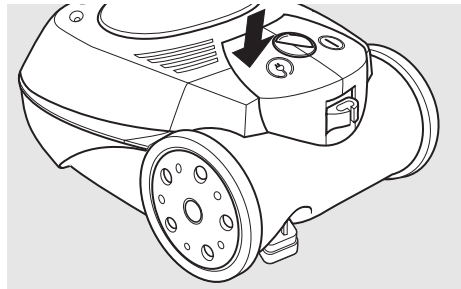

Storage

Tube park

The vacuum cleaner can be stored in an upright position. Rotate the floor nozzle until the lug on the back of it can be fitted into the tube park slot on the base of the appliance **8**.

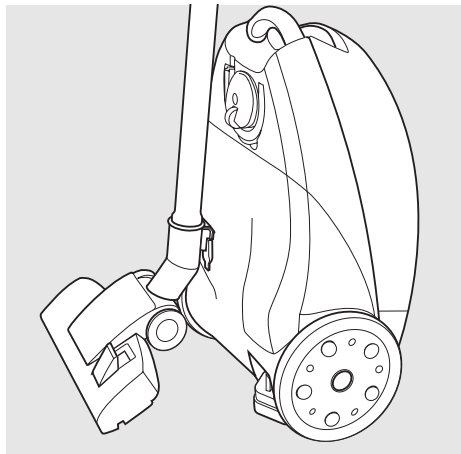

Changing the dustbag

If suction power is reduced or if the 'dust bag full' indicator **9** is permanently fully red, the dust bag needs changing. Also check whether the suction hose, tube or nozzle are blocked.

To access the dust bag, press the dust compartment release lever **10** to open the cover.

- 1** Pull the tab on the dust bag to one side so that the opening is hygienically sealed.
- 2** Pull out the dust bag holder and dust bag in an upward direction.
- 3** Pull the bag sideways out of the holder.
- 4** Dispose of the bag with your household waste.

- 5** Insert a new dust bag in the holder.
- 6** Replace the dust bag holder and close the cover.

IMPORTANT: The dust bag compartment cover can only be closed once a dust bag has been correctly fitted.

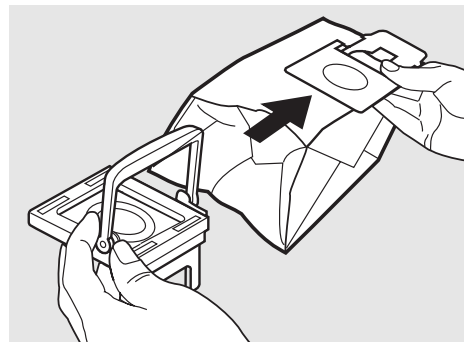
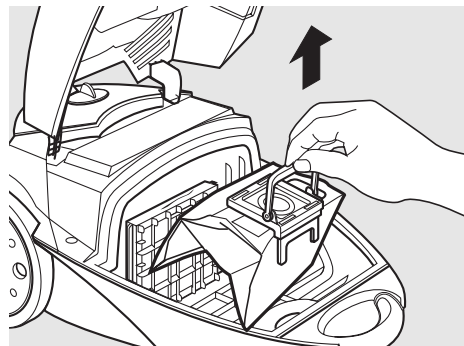
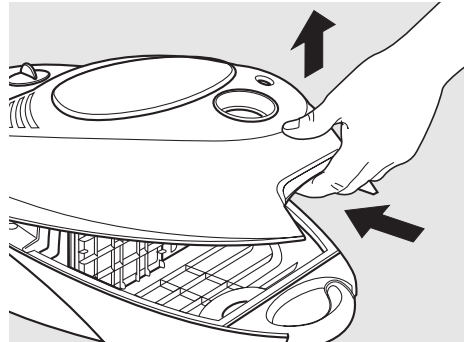

Changing/cleaning the motor protection filter

The motor protection is accessible from the dust compartment only when the dust bag has been removed first.

IMPORTANT: Never use the appliance without the motor protection filter installed, otherwise damage to the motor may occur which would not be covered by the guarantee.

- 1** Slide the filter upwards to remove.
- 2** Open the flap on the filter holder.
- 3** Take out the filter and clean (by shaking) or wash.
- 4** To wash the filter, gently wash in warm water and leave to air dry. Do not use detergents. Ensure the filter is fully dry before replacing into the machine.
- 5** Close the filter holder and place back into position before removed.

It is recommended that this filter is cleaned everytime the dustbag is changed, and is replaced every 5 dustbag changes.

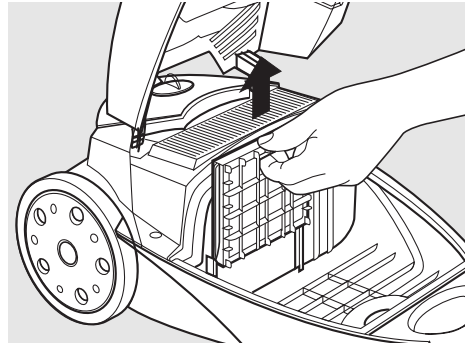

Changing/cleaning the exhaust air filter

The exhaust air filter should be cleaned by shaking every time the dustbag is changed. The exhaust filter is non-washable.

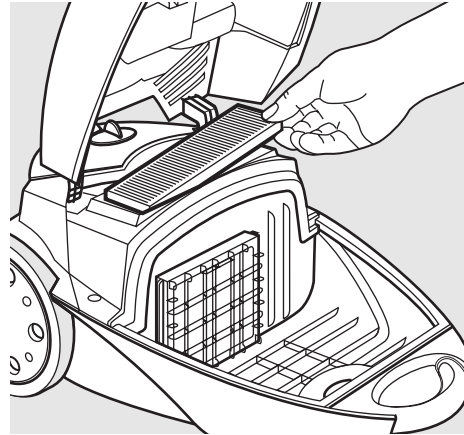

Cleaning and maintenance

Unplug from the mains before cleaning. The vacuum cleaner, especially the dust compartment and all accessories can be cleaned using a damp cloth or a non-abrasive domestic cleaner and wiped dry.

To keep the underside of the floor nozzle clean, vacuum it at regular intervals using the crevice tool.

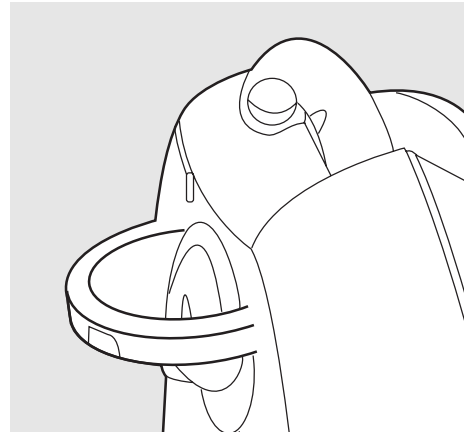

Stair lock

This unique system assists with stair cleaning. The stairhook, found underneath, is lifted out as shown and locked onto the stairs. In addition, the rear wheels automatically lock in position as further security.

After use, simply push the stairhook firmly back into position.

IMPORTANT: When cleaning on stairs, for convenience and safety, work from the bottom to the top with the desired accessory connected directly onto the hose handle. It is recommended not to use the extension tube.

Note: The stairlock mechanism makes a slight clicking sound when the wheels turn, this is normal.

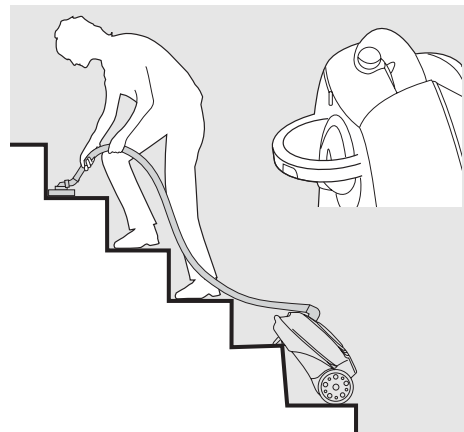

Purchasing dustbags replacement filters

Use only genuine replacement dustbags and filters which can be purchased from specialist retailers or by calling the number on the front page of this leaflet.

genuine
replacements

Helpline

If you have any difficulty with your appliance, do not hesitate to call us. We're more likely able to help than the store from where you bought it.

Please have the following information ready to enable our staff to deal with your query quickly:

- Name of the product
- Model number as shown on the underside of the appliance
- Serial number



Your two-year guarantee

- It is important to retain the retailers receipt as proof of purchase. Staple your receipt to this back cover for future reference.

Please quote the following information if the product develops a fault. These numbers can be found on the base of the product.

Model no. Serial no.

All Morphy richards products are individually tested before leaving the factory. In the unlikely event of any appliance proving to be faulty within 28 days of purchase it should be returned to the place of purchase for it to be replaced.

If the fault develops after 28 days and within 24 months of original purchase, you should contact the helpline quoting model number and serial number should you require further assistance. Repair or replacement of the product is subject to the exclusions set out below (1-6).

If you suspect a fault, follow the simple checks detailed below before returning the appliance or calling the helpline.

- Check the dust bag and filters for blockages.
- Check the hose and tubes for blockages.
- Check the plug is firmly in the socket and the supply is switched on.
- Make sure the socket is working by trying another appliance.

If for any reason this item is replaced during the two-year guarantee period, the guarantee on the new item will be calculated from original purchase date. Therefore it is vital to retain your original receipt or invoice to indicate the date of initial purchase.

To qualify for the two-year guarantee the appliance must have been used according to the manufacturers instructions.

Morphy richards shall not be liable to replace or repair the goods under the terms of the Guarantee where:

- The fault has been caused or is attributable to accidental use, mis-use, negligent use or used contrary to the manufacturers recommendations or where the fault has been caused by power surges or damage caused in transit.
- The appliance has been used on a voltage supply other than that stamped on the products.
- Repairs have been attempted by persons other than our service staff.
- Where the appliance has been used for hire purposes or non-domestic use.
- The guarantee excludes consumables such as bags and filters.
- Morphy richards are not liable to carry out any type of servicing work, under the guarantee.

This guarantee does not confer any rights other than those expressly set out above and does not cover any claims for consequential loss or damage. This guarantee is offered as an additional benefit and does not affect your statutory rights as a consumer.

- This guarantee is valid in the UK and Ireland only.



For additional information on Morphy richards products www.morphyrichards.com

Morphy richards products are intended for household use only

Morphy richards has a policy of continuous improvement in product quality and design. The Company, therefore, reserves the right to change the specification of its models at any time.

morphy richards[®]

The After Sales Division,
Registered address
Morphy richards Ltd, Mexborough,
South Yorkshire, England, S64 8AJ

Helpline (office hours)
UK 0870 060 2604
Republic of Ireland 1800 409119

VC70312M UK Rev 2 10/04